



SUN BOWL
STADIUM
THE UNIVERSITY OF CALIFORNIA

TECH SHEET



GENERAL INFORMATION

- **Lodges and GECU Terrace (see page 8-9)**
 - Outdoor Bar
 - 26 lodges each with a 6 seat capacity, premium chairs, refrigerator and television screen
- **Hunt Family Sky Lounge (see page 5-7)**
 - Indoor Club with seating capacity of 134
 - 4 Private suites each with a capacity of 18 seats
 - Wet Bars and Catering spaces
- Hunt Family Sky Lounge Floor Plan (see page 4)
- Party Deck & GECU Terrace Floor Plan (see page 8)
- Sun Bowl West Side Floor Plan (see page 10)
- Sun Bowl West Side TV Production Lot Floor Plan (see page 11)
- Press Box (see page 12)
- 4th floor above Hunt Family Sky Lounge provides places for video camera for televised events
- Approx. 7,900 parking spaces surrounding the Sun Bowl
- **Seating Chart with Capacity (See page 13)**
 - 180 line = 46,093
 - 220 line = 50,292
 - 240 line = 54,373

SUN BOWL SPECIFICATIONS

Power:

200 amps, 3-phase at south end of tunnel below the scoreboard

Sound:

Point source at south end above scoreboard

Control in west side press box

Microphone inputs on each side of field at 50-yd. line

Loading:

Tunnel on south side

Ramp 24' 10" wide, 82' long

Trucks can load onto field

Dressing Rooms (see page 3)

Locker room and dressing room with showers and restrooms each side of the tunnel downstairs

Large rooms each side of tunnel upstairs

Locker Rooms Floor Plan:

Lower East Locker Rooms

Lower West Locker Rooms

Upper East Locker Rooms

Upper West Locker Rooms

Intercom:

3-pin xlr jacks on each side of field at 50-yd. line

Control in west side press box

ClearCom intercom

Production Phones:

In house

Concessions:

18 concession stands

Parking:

DRIVING DIRECTIONS TO SUN BOWL STADIUM

From Interstate 10 (East):

Take the Schuster/Sun Bowl exit (18A) to Sun Bowl Drive. Proceed onto Sun Bowl Drive. Continue towards the roundabout and go straight. At the second roundabout, take a right onto Glory Road. The Sun Bowl Stadium will be on the right.

From Interstate 10 (West):

Take the Schuster/Sun Bowl exit (18A) to Sun Bowl Drive. Turn left at the light (Schuster Avenue). At the next light (Sun Bowl Drive), take a left onto Sun Bowl Drive. Continue towards the roundabout and go straight. At the second roundabout, take a right onto Glory Road. The Sun Bowl Stadium will be on the right.

LOCKER ROOM FLOOR PLANS

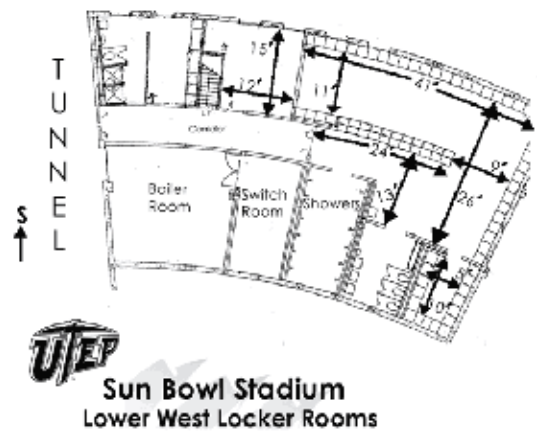
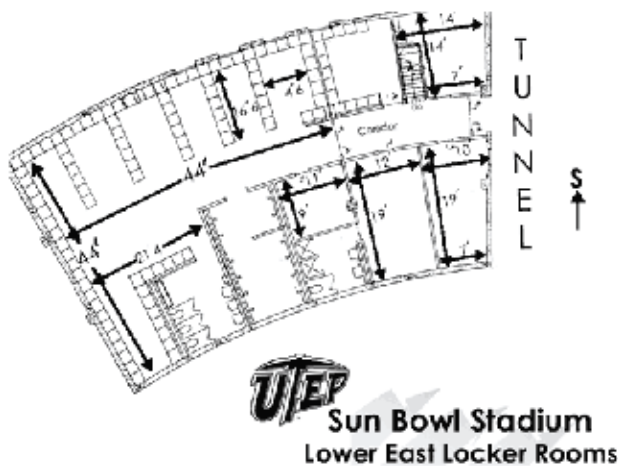
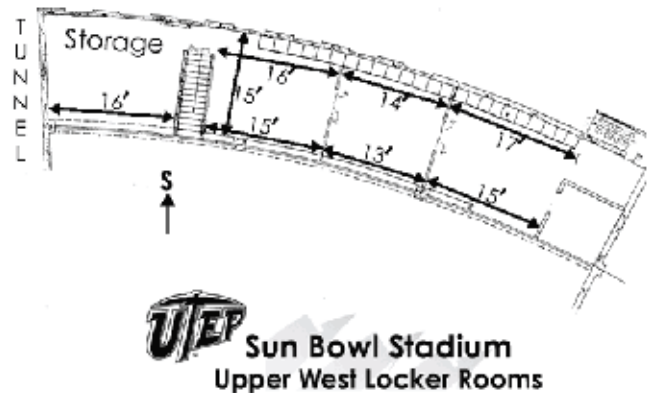
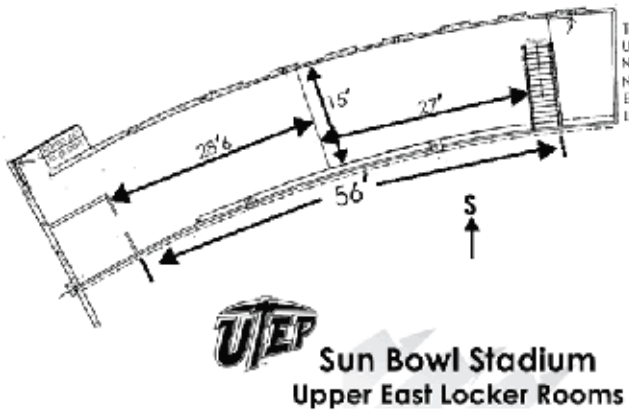

HUNT FAMILY SKY LOUNGE

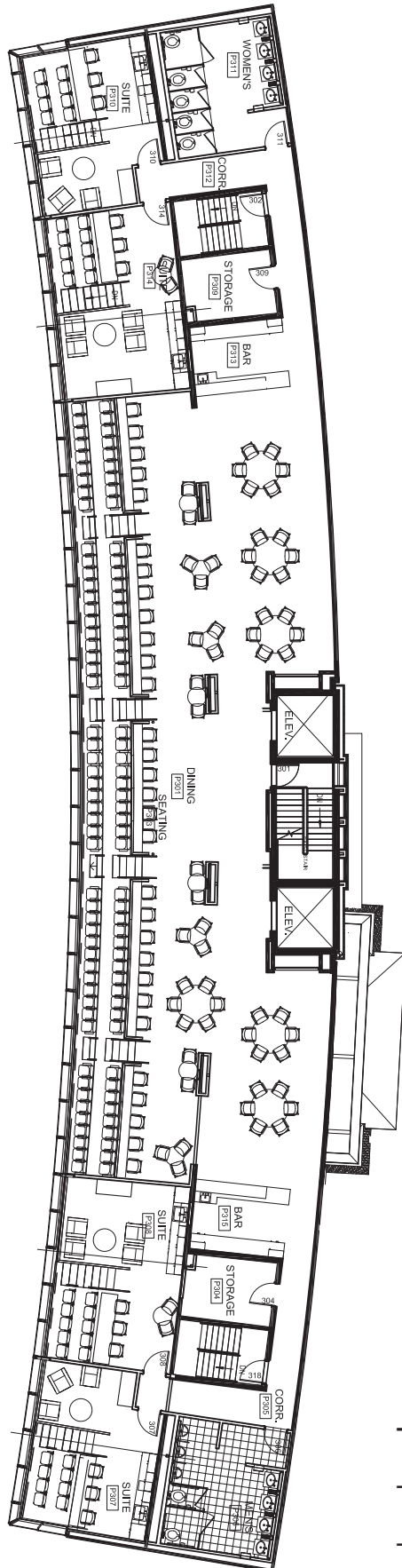

- Indoor Club with seating capacity of 134
- 4 Private suites each with a capacity of 18 seats
- Wet Bars and Catering spaces

HUNT FAMILY SKY LOUNGE

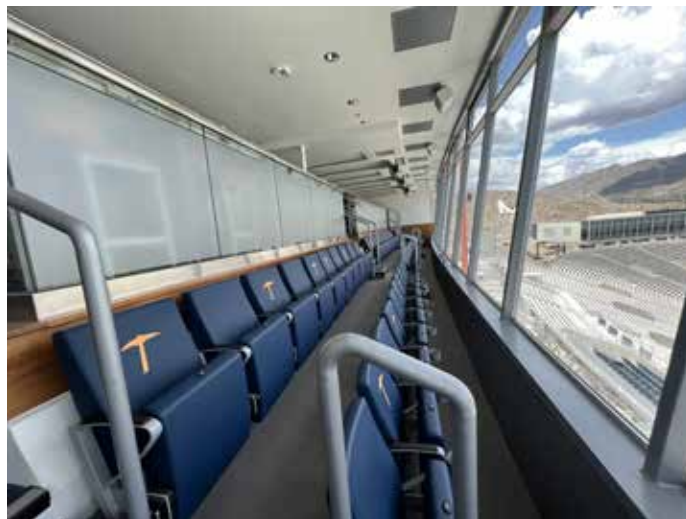
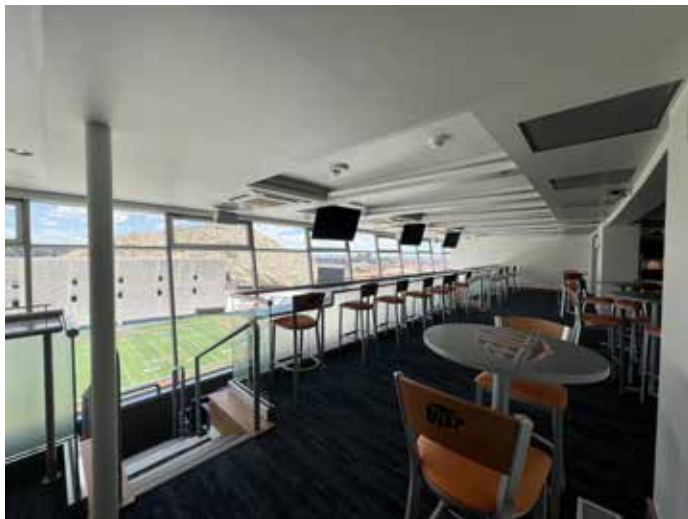

HUNT FAMILY SKY LOUNGE SUITES



HUNT FAMILY SKY LOUNGE

SOUTH WING



NORTH WING



PARTY DECK AND GECU TERRACE

SUN BOWL – FINAL OUTDOOR SEATING AND TABLES

BAR SEATING

- SEATS APPROX. 36
- BAR HEIGHT STOOLS

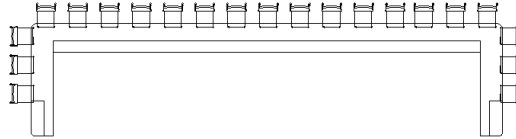

BAR HEIGHT STOOLS

SUN BOWL – FINAL OUTDOOR SEATING AND TABLES

TERRACE

- SEATS APPROX. 17
- BAR HEIGHT STOOLS
- QTY 7- 30" D BAR HEIGHT TABLES (NO CHAIRS)

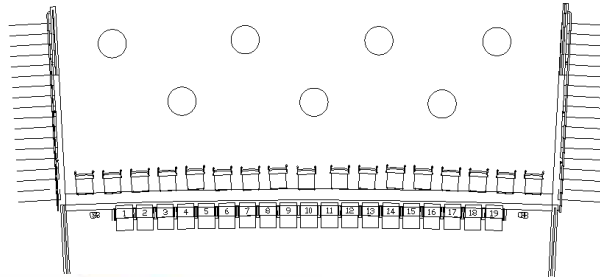

BAR HEIGHT TABLES



BAR HEIGHT STOOLS

SUN BOWL – FINAL OUTDOOR SEATING AND TABLES

PARTY DECK

- SEATS APPROX. 108
- BAR HEIGHT TABLES- 23/ BAR HEIGHT STOOLS-92
- STANDARD HEIGHT TABLES- 4/ STANDARD CHAIRS-16 (ADA compliant)

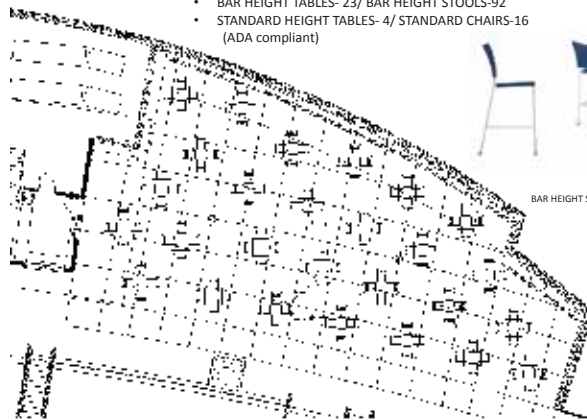

BAR HEIGHT STOOLS



BAR HEIGHT TABLES



STANDARD CHAIRS



STANDARD TABLES-ADA COMPLIANT

GECU TERRACE



LODGES



LODGES/ GECU TERRACE

- Outdoor Bar
- 26 lodges each with a 6 seat capacity, premium chairs, refrigerator and television screen

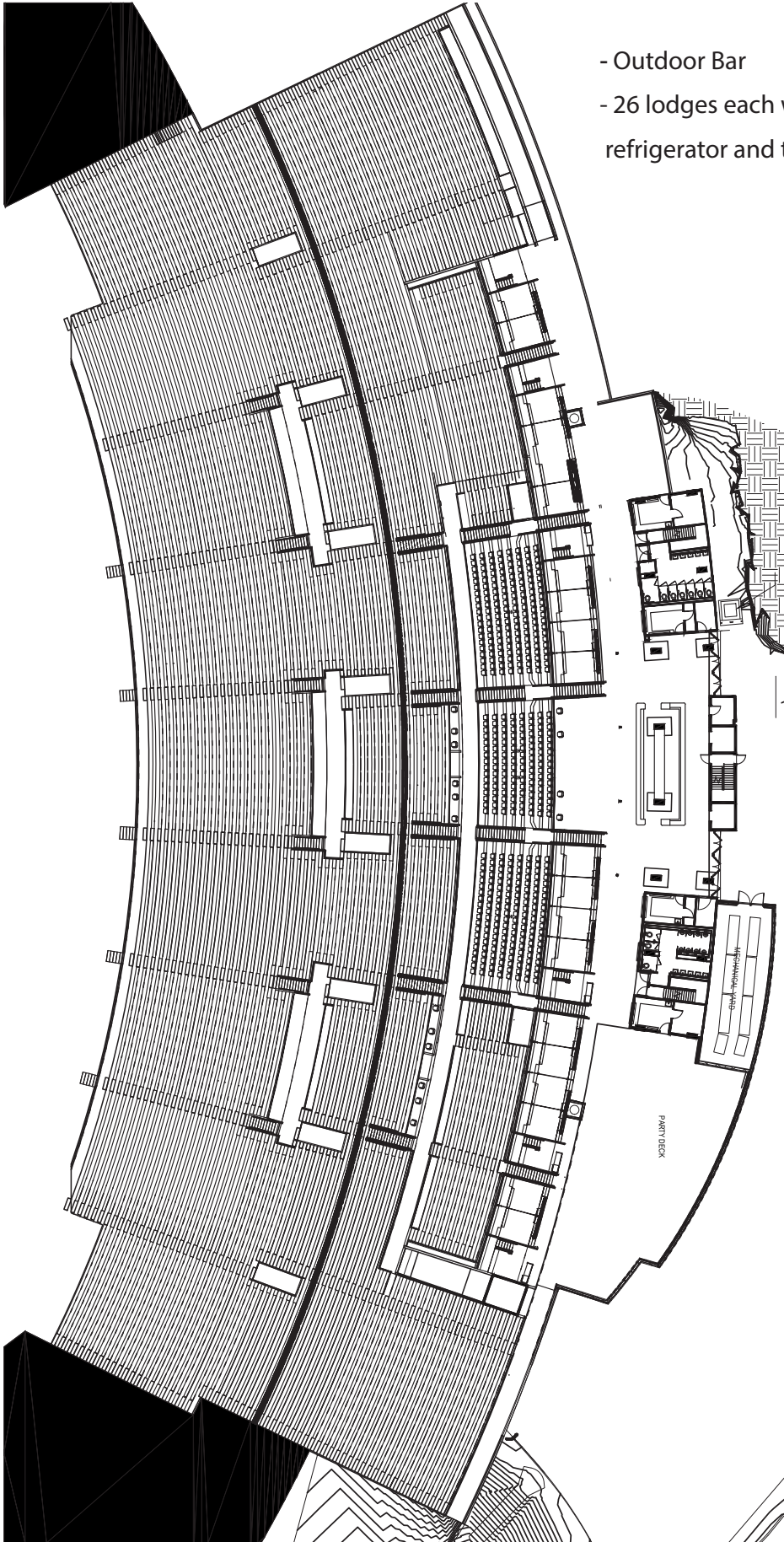

SUN BOWL WEST SIDE TV PRODUCTION LOT

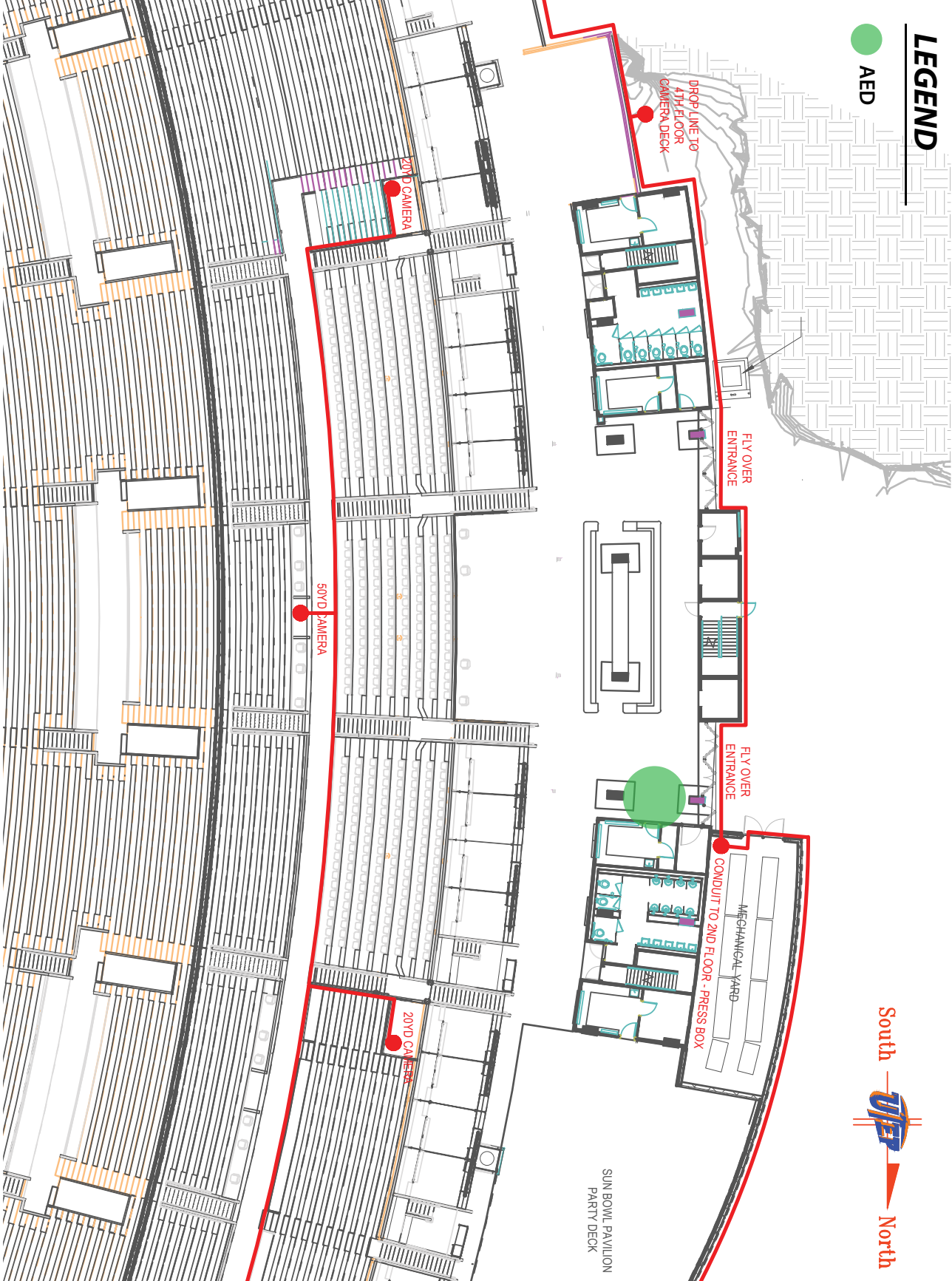



PRESS BOX

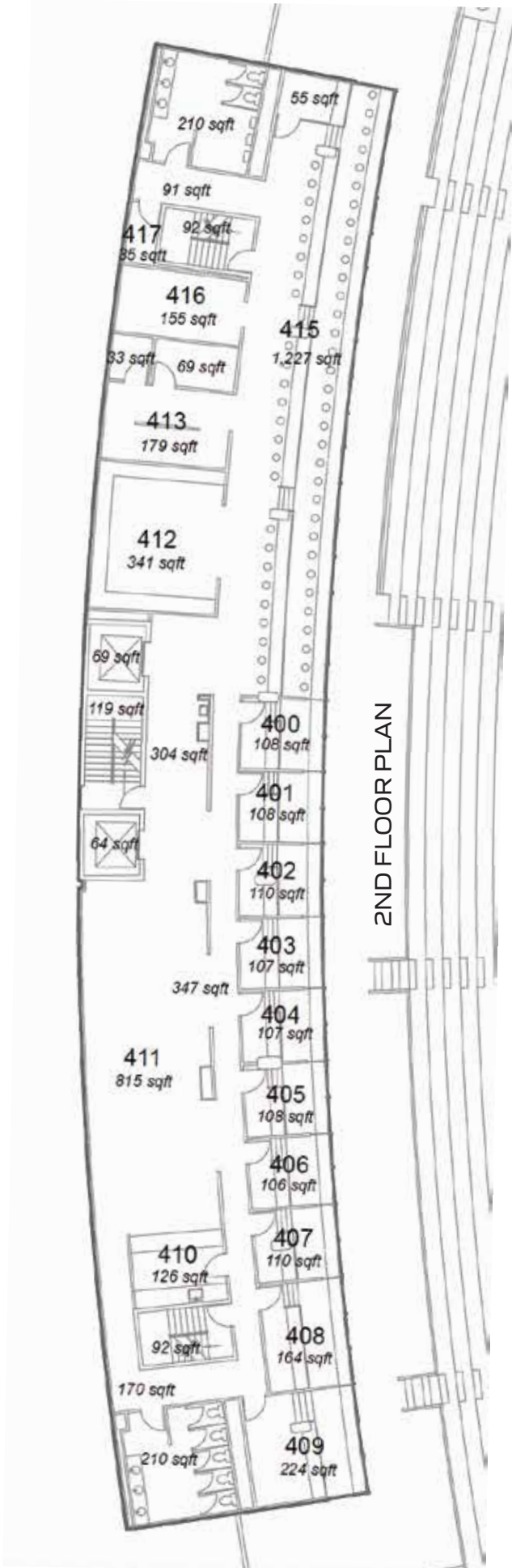

SUN BOWL CAPACITY



Total Gross Capacity: 46,098

180 line = 46,093

220 line = 50,292

240 line = 54,373